

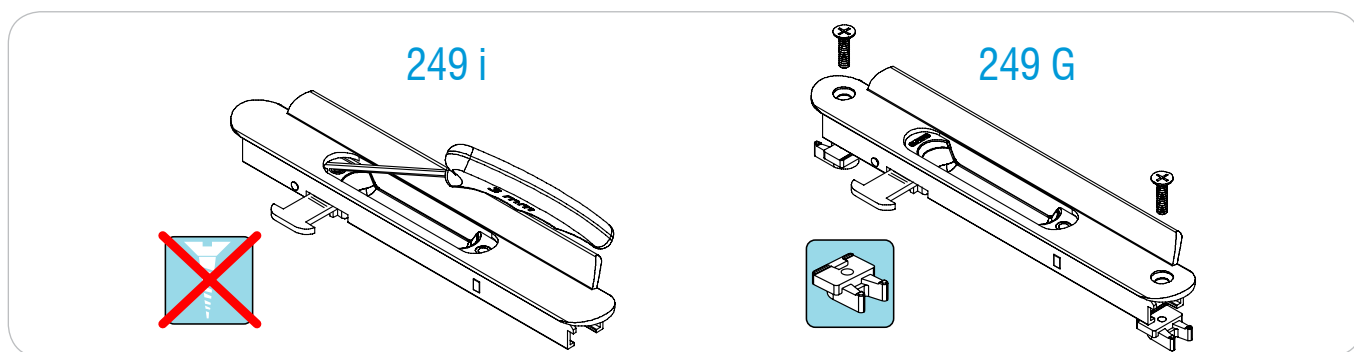
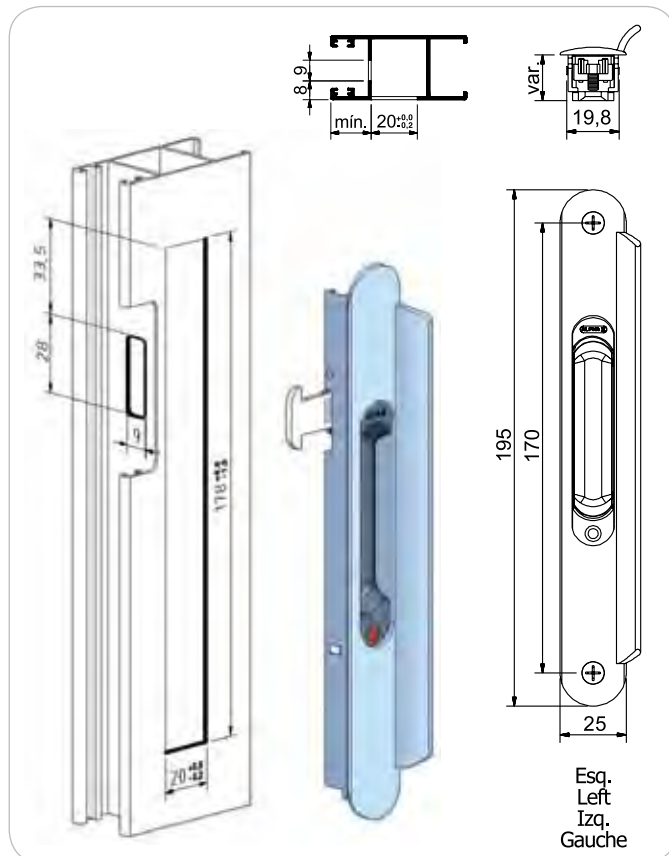
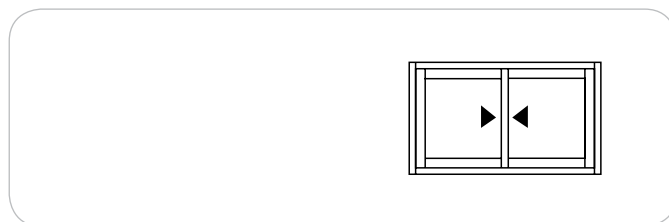

Mod. Dep.

RAL AN

**EMBALAGEM**

**249i** Caixa com 25 unidades. 3625 grs.  
**249G** Caixa com 25 unidades

**MATERIAIS**

Alumínio e zamak

**FIXAÇÃO**

Parafusos (incluídos)

**ACABAMENTO**

Lacado e anodizado

**NORMAS**

EN 1670

**OBSERVAÇÕES**

Fecho de embutir c/ recuperação manual. Gancho não incluído

**PACKAGING**

**249i** Box with 25 units. 3625 grs.  
**249G** Box with 25 units

**MATERIALS**

Aluminium and zamak

**FIXING**

Screws (included)

**FINISHING**

Powder painting and hard anodized

**STANDARD**

EN 1670

**COMMENTS**

Sliding lock with manual recovery.  
Hook not included

**EMPAQUETADO**

**249i** Caja con 25 unidades. 3625 grs.  
**249G** Caja con 25 unidades

**MATERIALES**

Aluminio y zamak

**FIJACIÓN**

Tornillos (incluídos)

**ACABADOS**

Lacado y anodizado

**NORMAS**

EN 1670

**OBSERVACIONES**

Cierre de embutir con recuperación manual. Gancho no incluído

**EMBALLAGE**

**249i** Boîte avec 25 pieces. 3625 grs.  
**249G** Boîte avec 25 pieces

**MATÉRIELS**

Aluminium et zamak

**FIXATION**

Vis (inclus)

**FINITIONS**

Laqué et anodisé

**NORMATIF**

EN 1670

**OBSERVATIONS**

Fermeture laterale avec retablisement manuel. Crochet pas inclus