

CHARNIÈRE 40/20 3 LAMES

DOBRADIÇA 40/20 3 PÁS

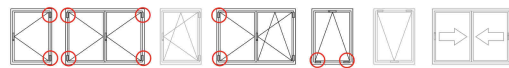

029	D	**
	I	**

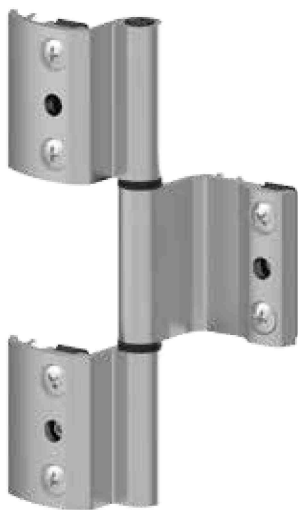

Charnière apte pour les séries conventionnelles type 4000 et 6000.

Dobradiça de três pás válida para séries convencionais tipo 4000 e 6000.

CARACTÉRISTIQUES TECHNIQUES:

- Contre-plaques montage rapide en zamak avec fixation écrous prisonniers.
- Charnière à montage rapide.
(Voir fiche technique)

CARACTERÍSTICAS TÉCNICAS:

- Contrachapados auto montáveis de zamak com cabeça interior sextavadas de fixação.
- Dobradiça de montagem rápida.
(Ver ficha técnica)

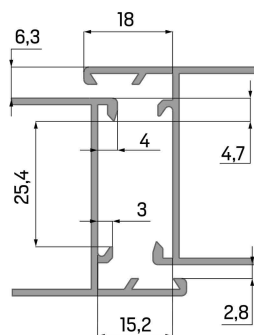
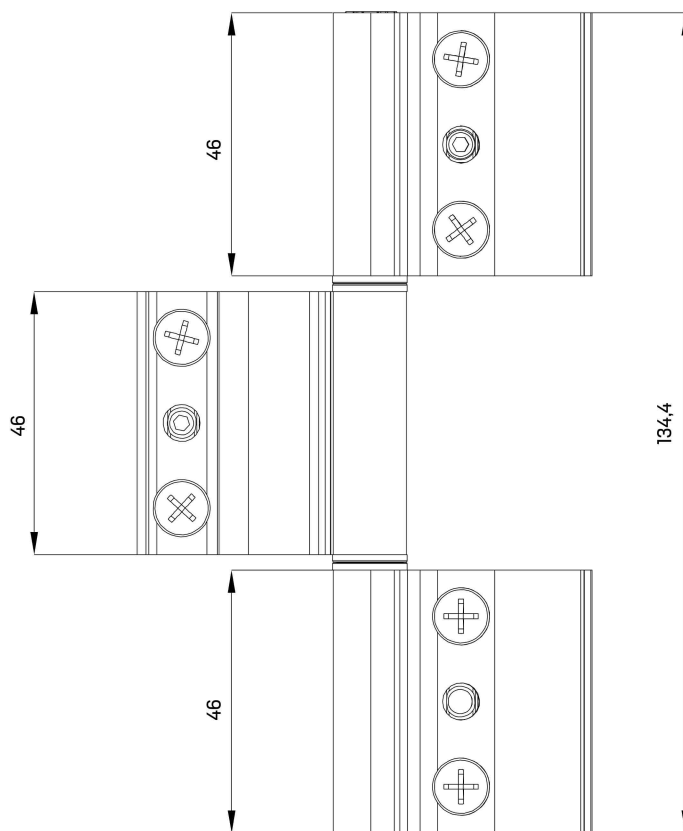

SERIES 6000

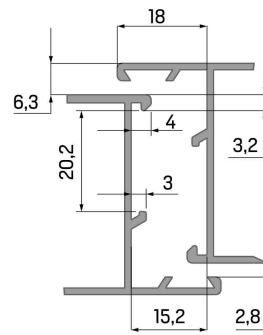

SERIES 4000